



BHAVESHWAR
VALENCIA

Plot No. 8, Sector - 26, Ulwe, Navi Mumbai.

START YOUR LEGACY



THE ROYAL WELCOME

The Magnificent 13 storey tower offers elegant 1 BHK & 2 BHK apartments. from the architectural planning to the smallest comfort, every little detail has been carefully thought out to give you an unparalleled living experience.







PROJECT HIGHPOINT

-  • CIDCO title Clear 22.5% Scheme Transfer Plot.
-  • G + 13 Storied Residential cum Commercial complex.
-  • Aesthetically designed 1, 2 BHK Flats and Shops
-  • Quality construction with earthquake resistant RCC structure.
-  • Rooftop Garden on Terrace
-  • Attractively Designed entrance Lobby.
-  • Society office & Fitness Center on the First Floor.
-  • Fully automatic high speed elevators.
-  • Ample Car parking space.
-  • Round the clock security.

- FLOORING**
-  • 32" X 32" Vitrified flooring in Living, Bedroom & Kitchen
 - Anti-skid flooring in Toilet & Bath

- KITCHEN**
-  • Granite Kitchen platform with S.S Sink
 - Designer glazed tiles upto beam height
 - Provision for water purifier point

- DOORS & WINDOWS**
-  • Decorative laminate main door with wooden frame
 - Decorative laminate internal doors with granite / wooden frame
 - Powder coated Aluminum sliding windows

- ELECTRIFICATION**
-  • Concealed copper wiring of polycab make with MCB's
 - Adequate electrical points in all rooms
 - ISI modular switches of premium make

- WALLS AND PAINTS**
-  • Putty finished internal walls
 - Emulsion paints for internal walls
 - Acrylic paints for external walls

- BATH & WC**
-  • Designer glazed tiles upto beam level
 - Good Quality sanitary wares of reputed make
 - Premium Quality C.P. Fittings
 - Provision for Exhaust Fan & Geyser point

- WATER TANK**
-  • Underground and Overhead water tank with adequate storage capacity

- TERRACE**
-  • Special water proofing treatment with China Chips flooring on top floor

INTERNAL HIGHPOINT





ROOFTOP LIFESTYLE IN THE SKY

PROJECT LIFESTLE



 1st floor Fitness Center



 Kids Play Area



 Rooftop Garden & Seating Area



Artist's Impression *



IN THE HEART OF IT ALL

LOCATION HIGHLIGHTS

CONNECTIVITY

- Kharkopar Station - 1km
- Baman Dongri Station - 1.5 km
- Seawoods Station - 9 km
- International Airport - 1 km
- Belapur Metro Station - 9 km
- MTHL - 1 km

EDUCATION

- DY Patil University - 11 km
- Kharghar Education Hub - 20 km
- Radcliff School - 1 km
- Ramsheth Thakur School Ulwe - 1.5 km
- Ryan International School, Nerul - 10 km
- Poddar International School, Nerul - 10 km
- Delhi Public School, Nerul - 7 km

MALLS

- Inorbit, Vashi - 16 km
- Grand Central, Seawoods - 9 km
- Little World Mall, Vashi - 13 km

HOSPITALS

- Apollo Hospital, Belapur - 9 km
- MGM Hospital, Belapur - 10 km
- DY Patil Hospital - 11 km

OTHERS

- NMMC Headquarter - 8 km
- Golf Course, Kharghar - 15 km
- DY Patil Stadium - 11 km
- ISKON Temple, Kharghar - 15 km
- Ramsheth Thakur Sports Complex - 1.6 km



Location guide



**2 BHK
FLAT**

ISOMETRIC VIEW

**1 BHK
FLAT**

ISOMETRIC VIEW

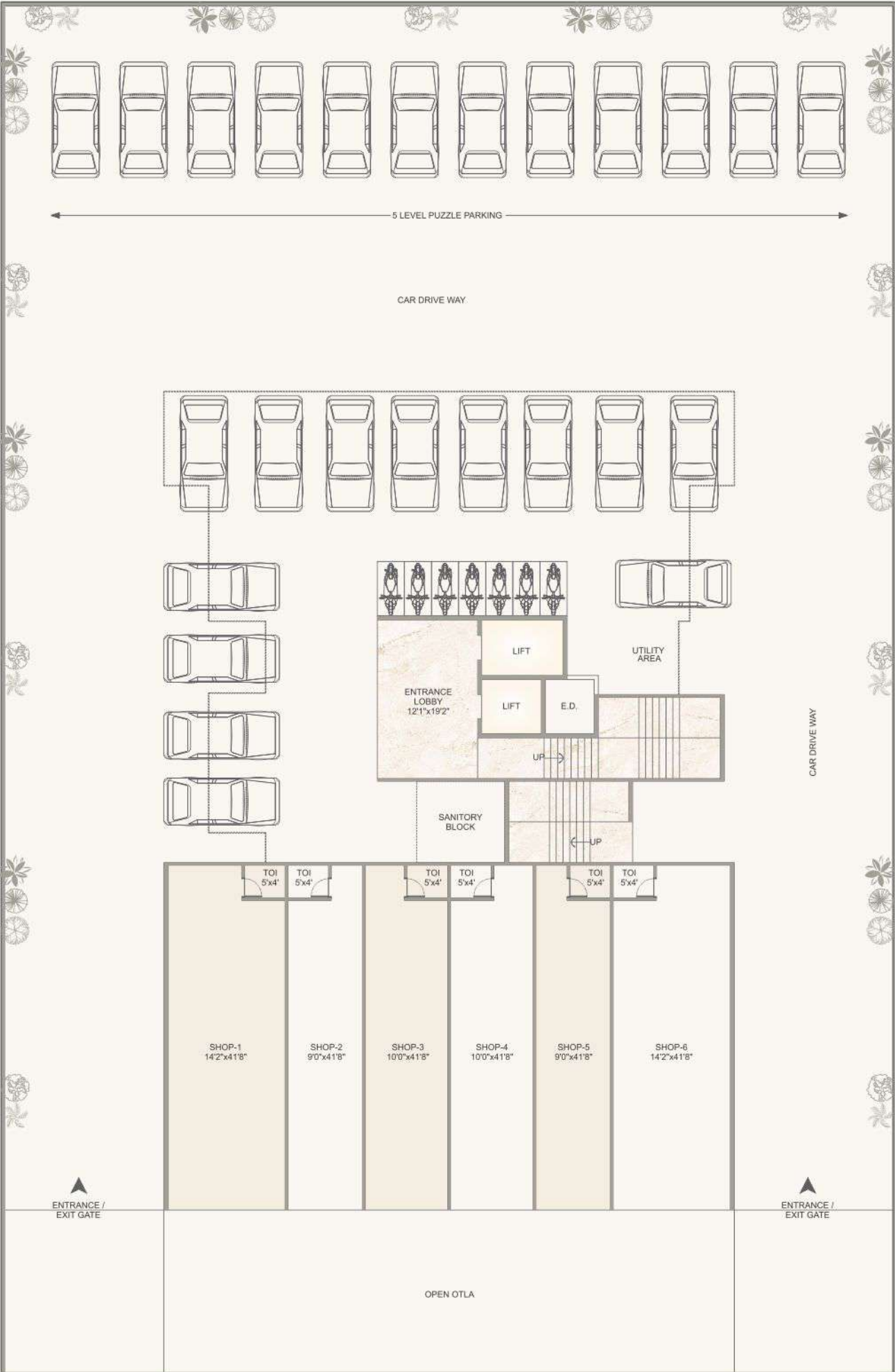

**GROUND
FLOOR
PLAN**

← 33.00 MT WIDE ROAD →

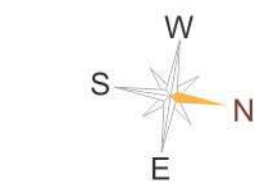

**1ST
FLOOR
PLAN**

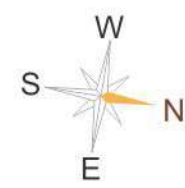

**2ND TO
11TH
FLOOR
PLAN**

A Project by :



BHAVESHWAR **CONSTRUCTION**

Site Address :

Plot No. 08, Sector - 26, Ulwe, Navi Mumbai.

Email : bhaveshwar2012@gmail.com

For Booking Call :

79771 09690 | 98926 77173 | 98209 55106 | 83695 86226

Architect :



ATUL PATEL
ARCHITECTS

RCC Consultants :

S. R. Rao Consultants



Maharera Registered No. P52000034410

<https://maharera.mahaonline.gov.in>

This Communication is purely conceptual & is not a legal offering. It is made for only promotional purpose. This information contained in this communication is only indicative of the kind of development that is proposed and is subject to change. The developers reserve the right to make change or alterations at their sole discretion.